

16mm Snap-in Insulated Shaft Potentiometers

PS16DV



Part Number

PS16DV - **B** **50K**, L - **20** **F**

↓ Taper ↓ Resistance Value ↓ Shaft Length ↓ Shaft Type

Dimensions

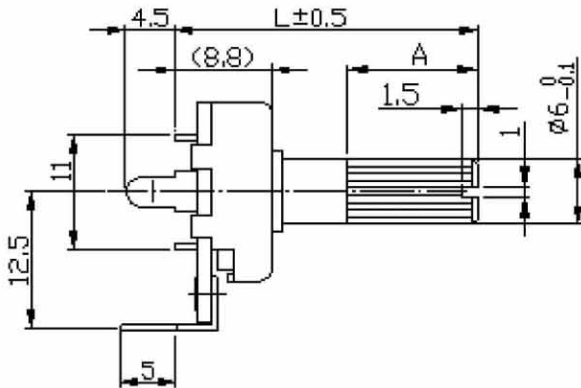

FULL C.C.W POSITION

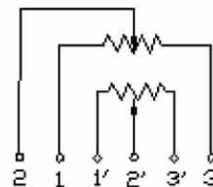
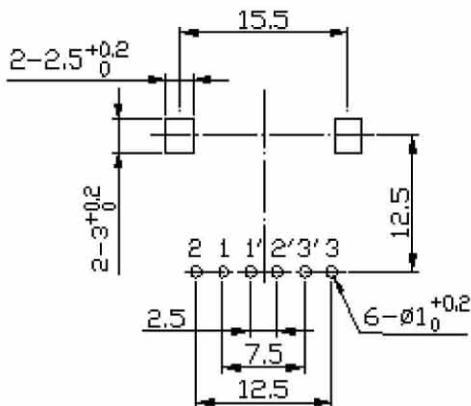
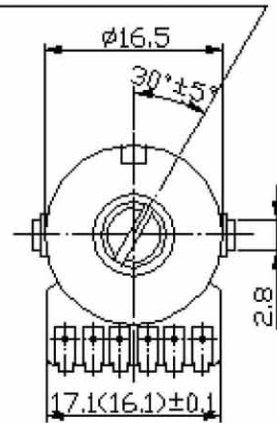

16mm Snap-in Insulated Shaft Potentiometers

Shaft Dimensions

KC TYPE
18TEETH

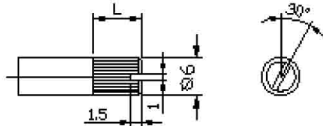

SHAFT SHOWN IN
FULL C.C.W. POSITION

HORIZONTAL WITH BUSHING

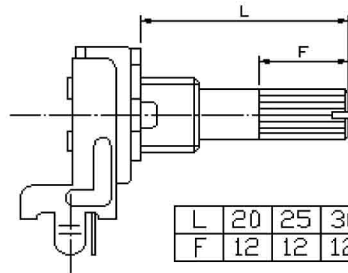

F Type

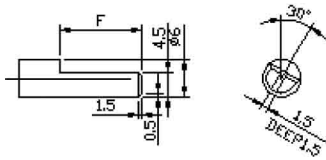

SHAFT SHOWN IN
FULL C.C.W. POSITION

F Type

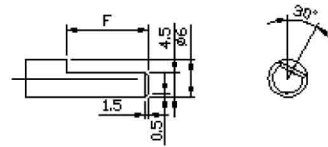

SHAFT SHOWN IN
FULL C.C.W. POSITION

Horizontal with bushing

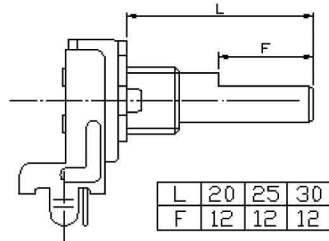

Bushing Dimension

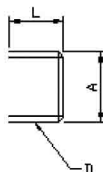

L	A	D	
7	ø9	M9x0.75	STD

Stopper Dimension

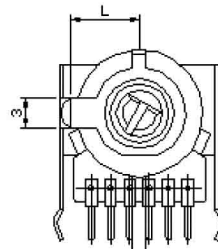

L	
9	SATNDARD