

Features

- Surface Mount 4mm Square/ Multi-turn Cermet / Industrial / Sealed
- Sealed to withstand board wash processing
- Pick and place centering design , with flush adjustment

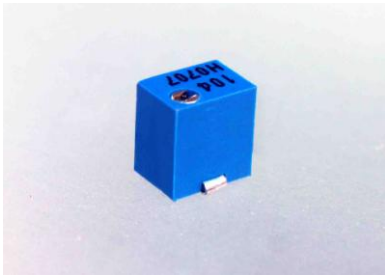

CE4MT-SMD-W

4mm Square; Top Adjust Trimmer Potentiometer

CE4MT-SMD-W

Electrical Characteristics

Standard Resistance Range
 10 to 1 meg Ω
 (see standard resistance table)
 Resistance Tolerance
 $\pm 10\%$ std. (others available)
 Absolute Minimum Resistance
 1% or 2 ohms max.
 (which ever is greater)
 Contact Resistance Variation
 3% or 3 ohms max.
 (which ever is greater)
 Resolution
 Essentially Infinite
 Insulation Resistance
 500 vdc
 1,000 meg Ω min.
 Dielectric Strength
 101.3 kPa 600 VAC
 8.5 k Pa 250 VAC
 Effective Travel
 11 turns nom.

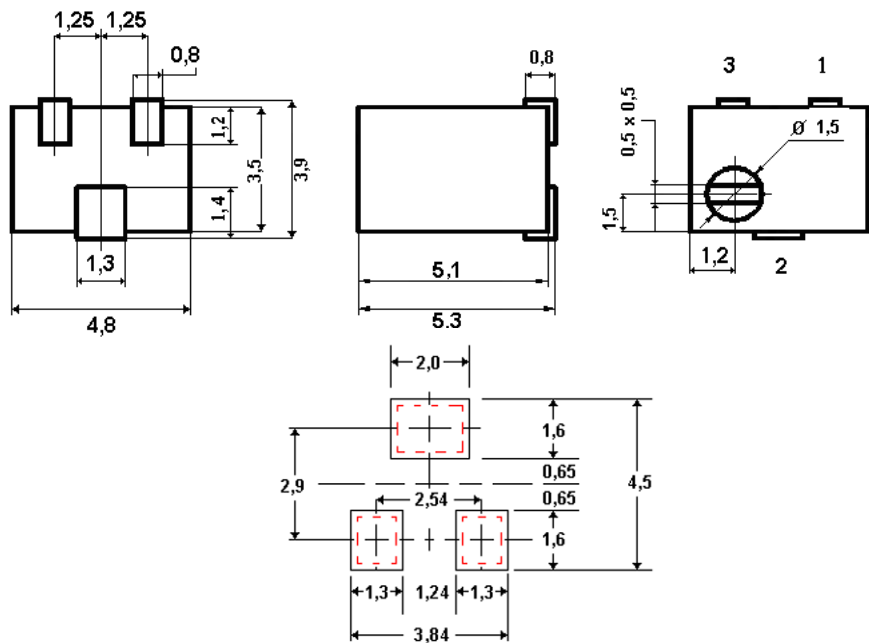

Environmental Characteristics

Power Rating (200 volts max.)
 0.25 watt (70°C) , 0 watt (125°C)
 Temperature Range
 -55°C to +125°C
 Temperature Coefficient
 ± 100 ppm/°C
 Vibration
 98 m/s²
 (1% Δ TR; 1% Δ VR)
 Shock
 490 m/s²
 (1% Δ TR; 1% Δ VR)
 Load Life
 1,000 hours 0.25 watt @ 70°C
 (3% Δ TR; 3% or 3 ohm,
 which ever is greater, CRV)
 Rotational Life
 200 cycles
 (3% Δ TR; 3% or 3 ohm,
 which ever is greater, CRV)
 Thermal Shock
 5 cycles
 (2% Δ TR; 1% Δ VR)

How to order

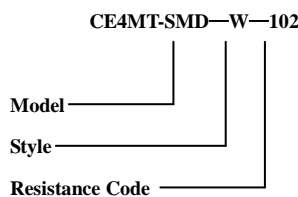

standard Resistance Table

Resistance (Ohms)	Resistance Code
10	100
20	200
50	500
100	101
200	201
500	501
1,000	102
2,000	202
5,000	502
10,000	103
20,000	203
25,000	253
50,000	503
100,000	104
200,000	204
250,000	254
500,000	504
1,000,000	105

Physical Characteristics

Torque
 25 mN · m max.
 Mechanical Stops
 Wiper idles
 Wiper
 Set at 50% nominal

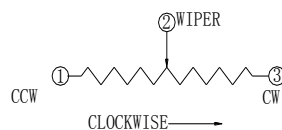

Special resistance available
 Detail Specification: Q/RYS15-2003