

- Multiturn/Rectangular/Cermet/Sealed
- 19 × 6.5 × 5

CE19MT-P Series Rectangular Trimming Potentiometer



Electrical Characteristics

Standard Resistance Range
 10 to 2 megohms
 (see standard resistance table)

Resistance Tolerance
 ± 10% std.
 (tighter tolerance available)

Absolute Minimum Resistance
 2 ohms max.

Contact Resistance Variation
 3% or 3 ohms max.
 (whichever is greater)

Adjustability
 Voltage ± 0.05%
 Resistance ± 0.15%

Resolution
 Infinite

Insulation Resistance
 500 Vdc
 1,000 megohms min.

Dielectric Strength
 101.3kPa 600 Vac
 8.5kPa 350 Vac

Effective Travel
 22 turns nom.

Environmental Characteristics

Power Rating (315 volts max.)
 0.5 watt (70°C), 0 watt (125°C)

Temperature Range
 -55°C to +125°C

Temperature Coefficient
 ± 100ppm/°C

Vibration
 98 m/s²
 (1% Δ TR, 1% Δ VR)

Shock
 390 m/s²
 (1% Δ TR, 1% Δ VR)

Load Life
 1,000 hours 0.5 watt @ 70°C
 (3% Δ TR, 4% or 4 ohms,
 Whichever is greater, CRV)

Rotational Life
 200 cycles
 (3% Δ TR, 4% or 4 ohms,
 Whichever is greater, CRV)

Physical Characteristics

Torque
 15 mN · m max.

Standard Packaging
 25 pcs. per tube

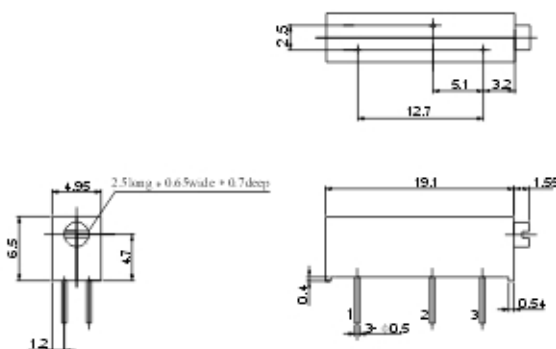

CE19MT-P

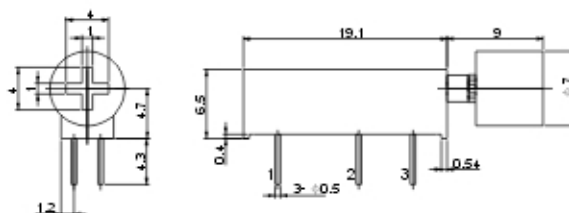

CE19MT-P-WT

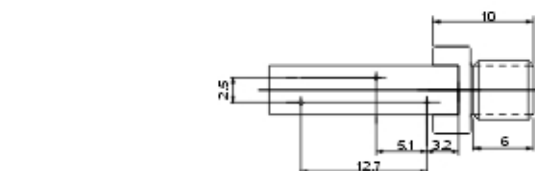

CE19MTB-P

How to order

CE19MT-P-102

Model ————

Style ————

Resistance Code ————

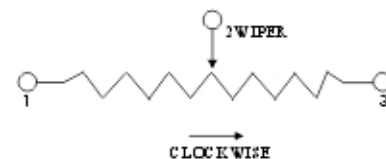

Standard Resistance Table

| Resistance (Ohms) | Resistance Code |
|-------------------|-----------------|
| 10 | 100 |
| 20 | 200 |
| 50 | 500 |
| 100 | 101 |
| 200 | 201 |
| 500 | 501 |
| 1,000 | 102 |
| 2,000 | 202 |
| 5,000 | 505 |
| 10,000 | 103 |
| 20,000 | 203 |
| 50,000 | 503 |
| 100,000 | 104 |
| 200,000 | 204 |
| 500,000 | 504 |
| 1,000,000 | 105 |
| 2,000,000 | 205 |

Special resistance available
 TCR of shaded areas ± 250ppm/°C

Detail Specification: Q/R Y106-2002
 Detail Mil-Spec: SJ20215-92