

- Single-Turn / Cermet / Industrial / Sealed
- Top and side adjust types

CE12ST Series Round Trimming potentiometer

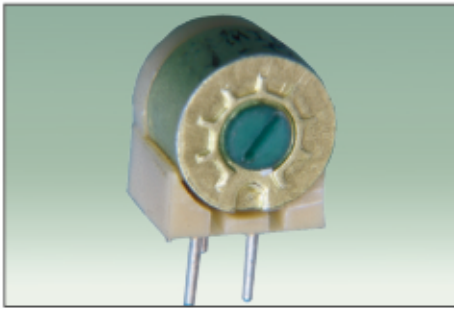

Electrical Characteristics

Standard Resistance Range
 50 to 5 megohms
 (see standard resistance table)

Resistance Tolerance
 $\pm 10\%$ or $\pm 20\%$ std.
 (tighter tolerance available)

Absolute Minimum Resistance
 1% or 2 ohms max.
 (whichever is greater)

Contact Resistance Variation
 4% or 4 ohms max.
 (whichever is greater)

Resolution
 Infinite

Insulation Resistance
 500 Vdc, 1,000 megohms min.

Dielectric Strength
 101.3kPa 750 Vac, 8.5kPa 350 Vac

Adjustment Angle
 $250^\circ \pm 10^\circ$ nom.

Environmental Characteristics

Power Rating (250 volts max.)
 1 watt (70°C), 0 watt (125°C)

Temperature Range
 -55°C to +125°C

Temperature Coefficient
 ± 100 ppm/°C

Vibration
 98m/s²
 (2% Δ TR; 2% Δ VR)

Shock
 390m/s²
 (2% Δ TR; 2% Δ VR)

Load Life
 1,000 hours 1watt @ 70°C
 (5% Δ TR; 8% or 8 ohms,
 Whichever is greater, CRV)

Rotational Life
 500 cycles
 (5% Δ TR; 8% or 8 ohms,
 Whichever is greater, CRV)

Physical Characteristics

Mechanical Angle
 $280^\circ \pm 10^\circ$ nom.

Torque
 40 mN·mm max.

Stop Strength
 50 mN·mm min.

How to order

CE12ST-P-102

Model ————

Style ————

Resistance Code ————

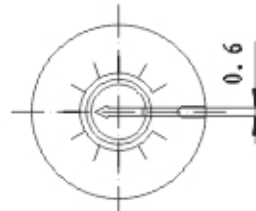
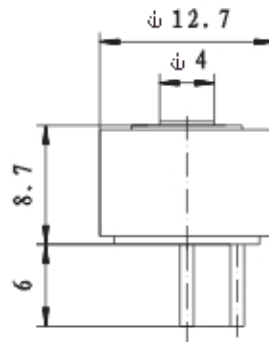
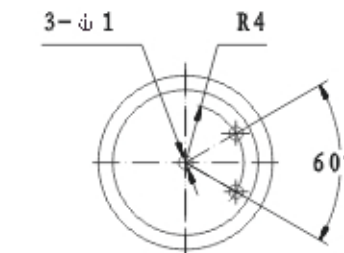

CE12ST-P

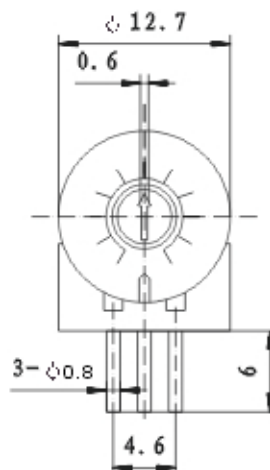

CE12ST-X

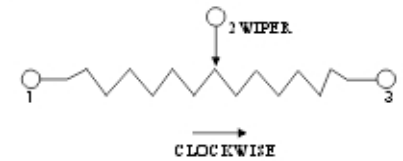

Standard Resistance Table

Resistance (Ohms)	Resistance Code
50	500
100	101
200	201
500	501
1,000	102
2,000	202
5,000	502
10,000	103
20,000	203
25,000	253
50,000	503
100,000	104
200,000	204
250,000	254
500,000	504
1,000,000	105
2,000,000	205
5,000,000	505

Special resistance available
 TCR of shaded areas ± 250 ppm/°C

Detail Specification: Q/RYS10-2002

