

**SCHEMATIC**

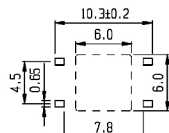

**PCB LAYOUT**

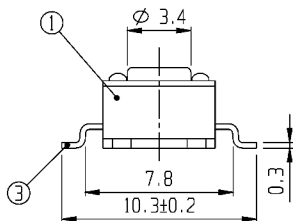
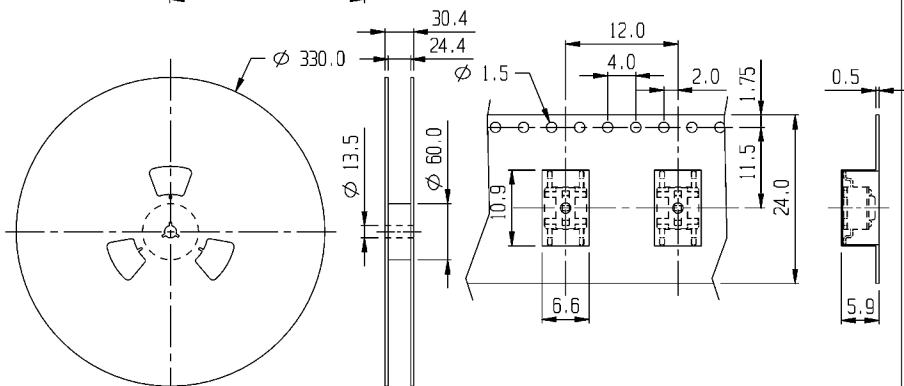

5	CONTACT	P B S	1	Ag PLATED					
3	TERMINAL	BRASS	4	Ag PLATED	4	COVER BOARD	SPCC	1	Ni PLATED
1	FRAME	NYLON 46	1		2	KNOB	NYLON 46	1	
NO	PART	MATERIAL	QTY	REMARKS	NO	PART	MATERIAL	QTY	REMARKS

<b>ISSUED</b>	<b>SPECIFICATION</b>	<b>TITLE: TACT SWITCH (SMD)</b>							
	RATING: DC 12V 50mA	<b>MODEL NO: TC-06104-00</b>							
	CONTACT RESISTANCE: 100mΩ Max.								
	INSULATION RESISTANCE: 100MΩ at 500V DC	TOLERANCE	UNIT: MM	DWN.					
	WITHSTAND VOLTAGE: AC 250V for 1 minute.	UP TO 1.0:±0.1	SCALE: 4:1	CHK'D.					
	OPERATION FORCE: REFER ATTACH SPECIFICATION	1.0 TO 10.0:±0.2	VERSION: 01	APPD.					
	SWITCHING LIFE: 100k Cycles Min.	OVER 10.0:±0.3	DRWG NO:						

BY: [Signature]  
DATE: 13-MAY-2005

