

SCHMATIC

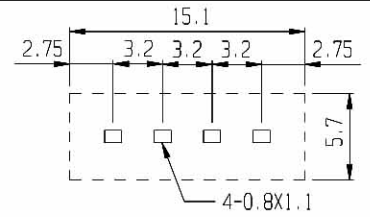

PCB LAYOUT

**RoHS  
Compliance**

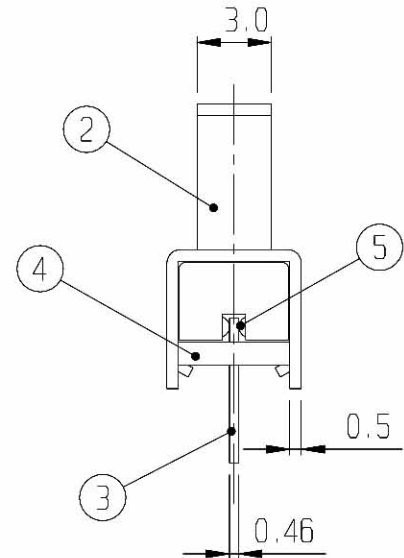
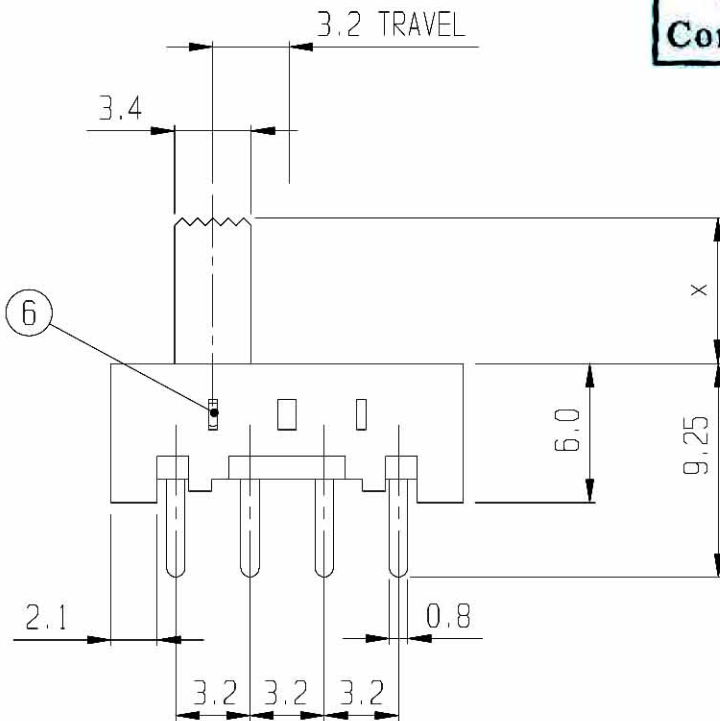

5	CONTACT	P B S	1	Ag PLATED	6	SPRING	STEEL WIRE	2	
3	TERMINAL	BRASS	4	Ag PLATED	4	TERMINAL BASE	PHENOL RESIN	1	NATURAL
1	FRAME	S P C C	1	Ni PLATED	2	KNOB	P O M	1	EG 3-10
NO	PART	MATERIAL	QTY	REMARKS	NO	PART	MATERIAL	QTY	REMARKS

ISSUED	SPECIFICATION	TITLE: SLIDE SWITCH (1P3T)							
	RATING: DC 30V 0.3A	MODEL NO: SS-13F11							
	CONTACT RESISTANCE: 30mΩ max.								
	INSULATION RESISTANCE: 500MΩ at 500V DC	TOLERANCE	UNIT: MM	DWN.	<i>hms</i>				
	WITHSTAND VOLTAGE: AC 500V for 1 minute	UP TO 1.0:±0.1	SCALE: 3:1	CHK'D.	<i>ms</i>				
	OPERATION FORCE: REFER ATTACH SPECIFICATION	1.0 TO 10.0:±0.2	VERSION: 04	APPD.	<i>[Signature]</i>				
	SWITCHING LIFE: 10K cycles min.	OVER 10.0:±0.3	DRWG NO:						

BY: *[Signature]*  
DATE: 11-NOV-2005

