

9mm Metal Shaft Rotary Potentiometer

V9M-G(8R) X8

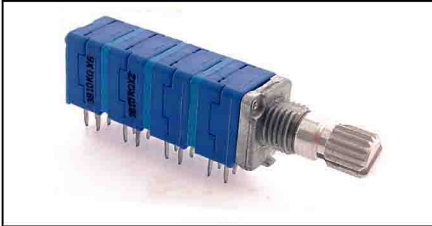

Part Number

V9M-G(8R) X8 - B 50K , L- 20 KC / N=5

↓ Resistance value ↓ Shaft Length ↓ Shaft Type
 Taper Bush Length

Dimensions

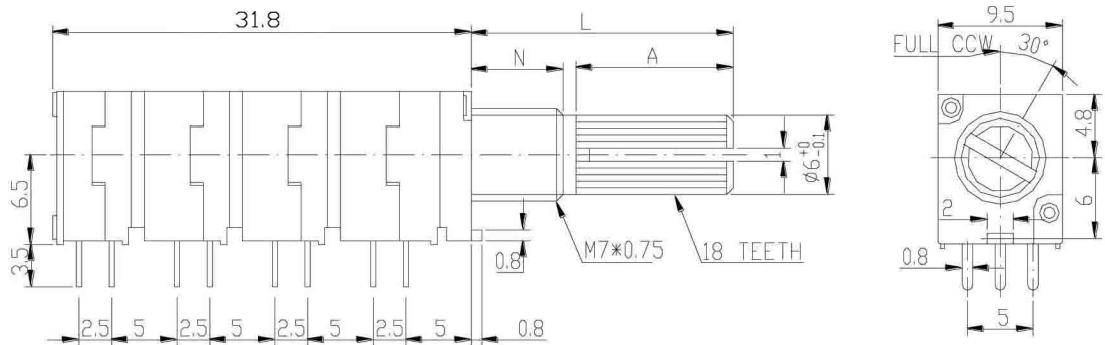

CIRCUIT

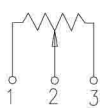

PCB LAYOUT

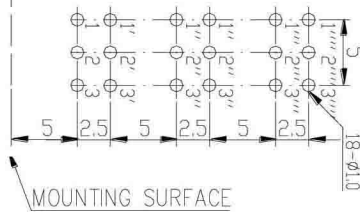

Shaft Type

KC Type

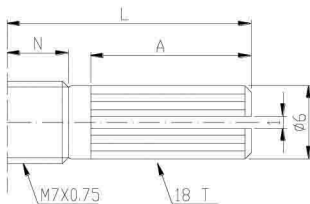

| | | | |
|-------|------|--------|------|
| N=5mm | | | |
| L | 10KC | 12.5KC | 15KC |
| A | 4 | 7 | 12 |
| N=7mm | | | |
| L | 15KC | 20KC | 25KC |
| A | 7 | 12 | 12 |

F Type

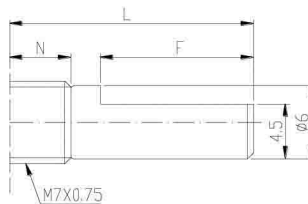

| | | |
|-------|-----|-----|
| N=5mm | | |
| L | 15F | 20F |
| F | 7 | 12 |
| N=7mm | | |
| L | 15F | 20F |
| F | 7 | 12 |

RE Type

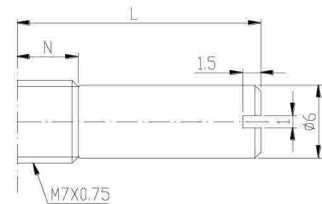

| | | |
|-------|------|------|
| N=5mm | | |
| L | 8RE | 10RE |
| N=7mm | | |
| L | 15RE | |