

9mm Metal Shaft Rotary Potentiometer

V9M-G(6R) X6

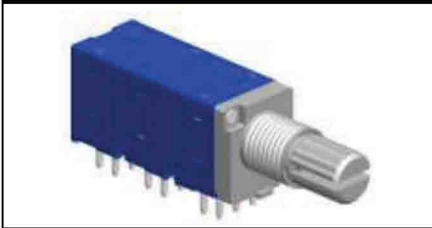

Part Number

V9M-G(6R) X6 - B 50K , L- 20 KC / N=5

Taper
 Resistance value
 Shaft Length
 Shaft Type
 Bush Length

Dimensions

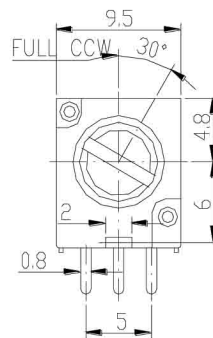
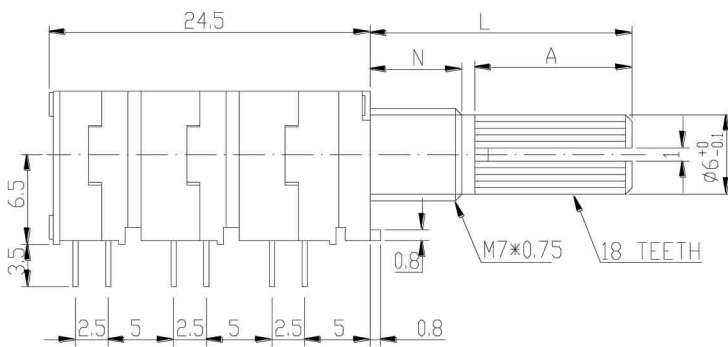

PCB LAYOUT

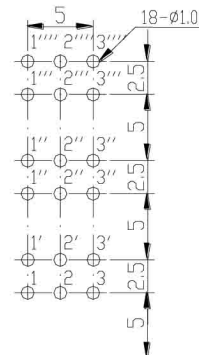

MOUNTING SURFACE

CIRCUIT

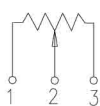

Shaft Type

KC Type

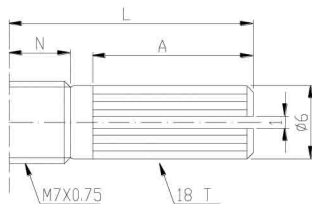

N=5mm			
L	10KC	12.5KC	15KC
A	4	7	7
			12
N=7mm			
L	15KC	20KC	25KC
A	7	12	12

F Type

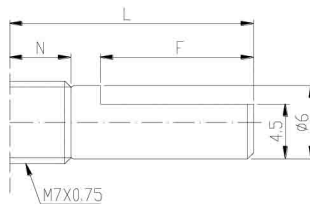

N=5mm		
L	15F	20F
F	7	12
N=7mm		
L	15F	20F
F	7	12
		12

RE Type

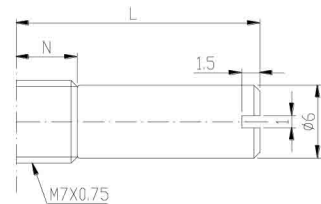

N=5mm		
L	8RE	10RE
		15RE
N=7mm		
L	15RE	