

P.C.B. LAYOUT

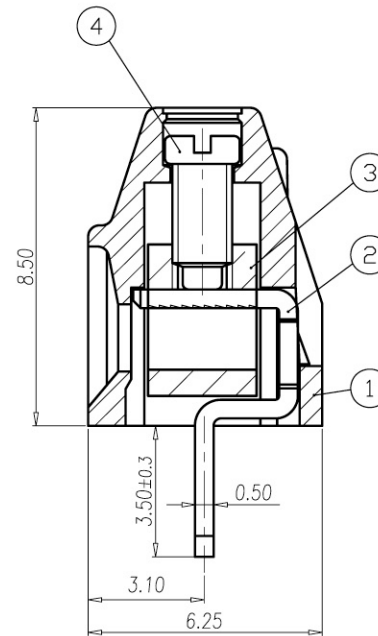
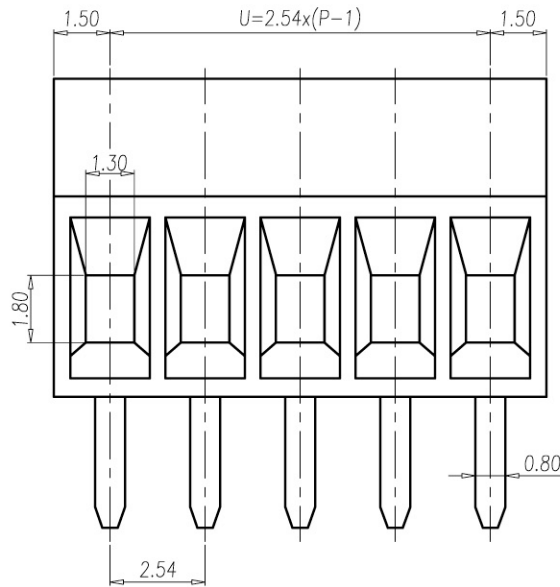

NOTES:

1. Rating: UL 150V 10A  
PITCH: 2.54mm
2. Insulation Withstands Voltage:  
AC 1000 V at 1 minute
3. Insulation Resistance:  
1000MΩ or more at DC500V
4. Using Temperature Range:  
-40°C~+130°C
5. Suitable Electric Wire: AWG28~16
6. Screw Torque Value: 2kgf-cm
7. RoHS Compliance

ITEM	NAME OF PART	MATERIAL	NOTES
4	SCREW	STEEL	M1.6/Zn Plated
3	WIRE CAGE	COPPER ALLOY	Ni Plated
2	SOLDER PIN	COPPER ALLOY	Tin Plated
1	HOUSING	PA66	UL94-V0 GREEN

Normal Geometric Tolerancing			
—	//	≡	⊥
0 to 100	0.2	0 to 10	0.2
over 100 to 150	0.3	over 10	0.3
over 150	0.5		
Total Pitch Tolerances		Normal dimension Tolerances	
0<U≤30	±0.20	0~30	±0.25
30<U≤53	±0.25	over 30~53	±0.30
53<U≤70	±0.30	over 53~70	±0.35
70<U≤90	±0.35	over 70~90	±0.44
90<U≤115	±0.44	over 90~115	±0.55
115<U≤150	±0.55	over 115~150	±0.70
150<U≤200	±0.70	over 150~200	±0.85
200<U≤250	±0.85	over 200~250	±1.00
250<U≤320	±1.00	over 250~320	±1.20

DWG.	MXB	DATE	09.08.26	UNITS	MM	SHEET/OF	1 / 1
CHK.		DATE		SCALE	7:1 ( : )		
APP.		DATE		Part Number	VCC254V-2.54-XXP-14		
REV.		DATE		DWG No.	254V-03		

REV.	CONTENT	CHK.	DATE

